

Socket with internal TX profile 1/2" - 191/1

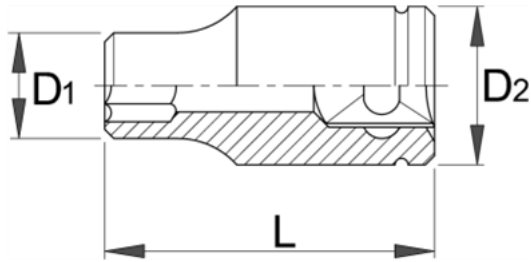

Description

- material: chrome vanadium
- drop forged, entirely hardened and tempered
- surface finish: chrome plated according to EN12540
- polished

Technical Data

| Barcode | Hex | D2 | D1 | L | Weight | Box | Carton | |
|---------|------|----|------|----|--------|-----|--------|---|
| 607141 | E 10 | 22 | 14 | 38 | 58 | 4B | 10 | - |
| 607142 | E 11 | 22 | 15 | 38 | 52 | 4B | 10 | - |
| 607143 | E 12 | 22 | 15 | 38 | 55 | 4B | 10 | - |
| 607144 | E 14 | 22 | 17 | 38 | 57 | 4B | 10 | - |
| 607145 | E 16 | 22 | 19 | 38 | 62 | 4B | 10 | - |
| 607146 | E 18 | 22 | 21 | 38 | 78 | 4B | 10 | - |
| 607147 | E 20 | 26 | 23 | 40 | 95 | 4B | 10 | - |
| 607148 | E 22 | 26 | 25.3 | 40 | 105 | 4B | 10 | - |
| 607149 | E 24 | 28 | 27.3 | 40 | 119 | 4B | 10 | - |

Packaging data

| Barcode | Hex | Retail tool packaging | | | | | Transport package | | | |
|---------|------|-----------------------|----|----|--------|-----|-------------------|-----|----|--------|
| | | A | B | C | Weight | Box | A1 | B1 | C1 | Weight |
| 607141 | E 10 | 110 | 44 | 43 | 63 | 4 | 94 | 150 | 59 | 377 |
| 607142 | E 11 | 110 | 44 | 43 | 57 | 4 | 94 | 150 | 59 | 353 |
| 607143 | E 12 | 110 | 44 | 43 | 60 | 4 | 94 | 150 | 59 | 365 |
| 607144 | E 14 | 110 | 44 | 43 | 62 | 4 | 94 | 150 | 59 | 373 |
| 607145 | E 16 | 110 | 44 | 43 | 67 | 4 | 94 | 150 | 59 | 393 |
| 607146 | E 18 | 110 | 44 | 43 | 83 | 4 | 94 | 150 | 59 | 457 |
| 607147 | E 20 | 110 | 44 | 43 | 100 | 4 | 94 | 150 | 59 | 525 |
| 607148 | E 22 | 110 | 44 | 43 | 110 | 4 | 94 | 150 | 59 | 565 |
| 607149 | E 24 | 110 | 44 | 43 | 124 | 4 | 94 | 150 | 59 | 621 |