

Magnetic tray

2086



Usage



Profiles



[_\(/eng/support/warranty\).](http://eng/support/warranty)

Product features

- Material: stainless steel, corrosion resistant
- keeps parts and tools right where you need them
- holds any small nuts, bolts and steel parts

Advantages:

- powerful permanent magnet covers with protective rubber foot
- can be used in any position

How to use the tool:

- With its powerful rubber-protected magnet, this magnetic tray is suitable for practically all industrial applications ranging from car repair shops to everywhere where it can be attached to a metal surface. It can be used in all positions - the magnet is so powerful that the

tray can even be fitted upside-down. The tray is intended for protecting screws, nuts and the like against being misplaced, and for storing them in a central location to minimise the time needed to find a specific item.

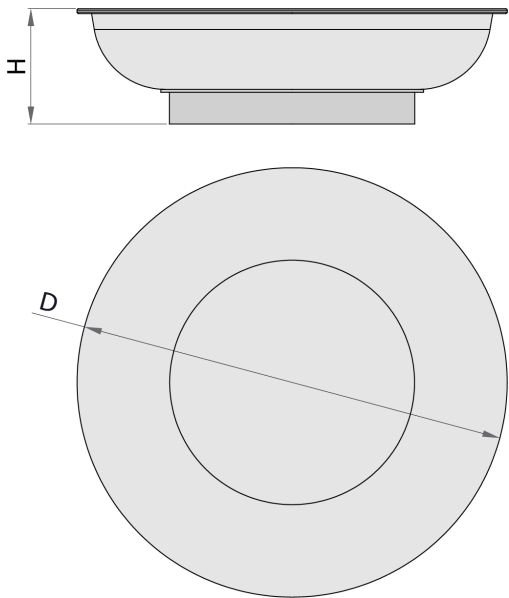

for usage in garage, engine,
household work

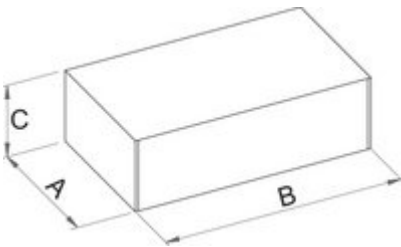

	D	H		
619728	150	40	3	387



Retail packaging

	MA	MB	MC	
619728	165	165	53	457

Transport packaging

		TA	TB	TC	
619728	1				