

Impact socket 3/8" - 230/4 6p

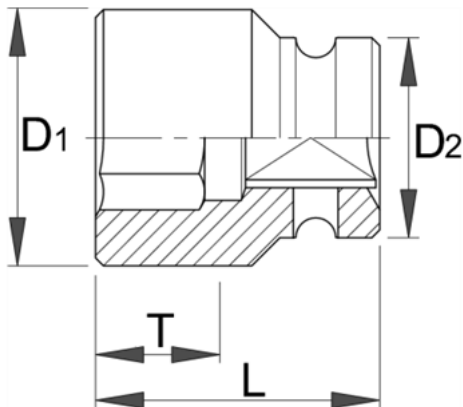

Description

- material: chrome molybdenum
- drop forged, entirely hardened and tempered
- surface finish: phosphated to standard DIN 12476
- made according to standard ISO 2725-2 (only metric dimension)

Technical Data

Barcode	Hex Size	D2	D1	L	T	Weight	Material	Surface	Standard
612060	8	19	13.8	30	8	45	4B	10	-
612061	9	19	15	30	8	45	4B	10	-
612062	10	19	16.3	30	8	45	4B	10	-
612063	11	19	17.5	30	9	45	4B	10	-
612064	12	19	19	30	9	45	4B	10	-
612065	13	22	20	30	10	61	4B	10	-
612066	14	22	21.3	30	11	55	4B	10	-
612067	15	22	22	30	11	58	4B	10	-
612068	16	22	24	30	12	65	4B	10	-
612069	17	22	25	30	12	65	4B	10	-
612070	18	22	26	30	12	69	4B	10	-
612071	19	22	27.5	30	19	66	4B	10	-
612072	20	22	28	30	13	66	4B	10	-
612073	21	22	30	30	13	73	4B	10	-
612074	22	23	32	30	13	86	4B	10	-

Packaging data

Barcode	Hex Size	Retail tool packaging					Transport package			
		A	B	C	Weight	Volume	A1	B1	C1	Weight
612060	8	100	44	34	50	4	83	131	55	325
612061	9	100	44	34	50	4	83	131	55	325
612062	10	100	44	34	50	4	83	131	55	325
612063	11	100	44	34	50	4	83	131	55	325
612064	12	100	44	34	50	4	83	131	55	325
612065	13	100	44	34	66	4	83	131	55	389
612066	14	100	44	34	60	4	83	131	55	365
612067	15	100	44	34	63	4	83	131	55	377
612068	16	100	44	34	70	4	83	131	55	405
612069	17	100	44	34	70	4	83	131	55	405
612070	18	100	44	34	74	4	83	131	55	421
612071	19	100	44	34	71	4	83	131	55	409
612072	20	100	44	35	71	4	83	131	55	409
612073	21	100	44	36	78	4	83	131	55	437
612074	22	100	44	37	91	4	83	131	55	489