

Impact extension bar 1/2" - 231.4/4

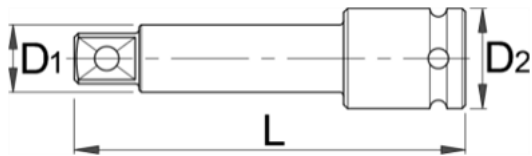

Description

- material: chrome molybdenum
- drop forged, entirely hardened and tempered
- surface finish: phosphated to standard DIN 12476

Technical Data

Barcode	Color	L	D1	D2	Weight	Material	Surface	Finish
603978	1/2"	75	16.9	25	148	1E	5	-
603977	1/2"	125	16.9	25	230	1E	5	-

Packaging data

Barcode	Retail tool packaging					Transport package				
	L	A	B	C	Weight	Volume	A1	B1	C1	Weight
603978	75	125	100	25	148	1	-	-	-	-
603977	125	235	80	25	230	1	-	-	-	-