

## Impact socket 1/2" with special protect profile - 231/4NS

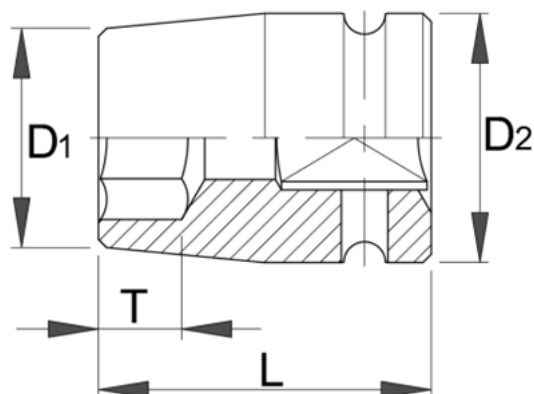

### Description

- material: chrome molybdenum
- drop forged, entirely hardened and tempered
- surface finish: phosphated to standard DIN 12476
- made according to standard ISO 2725-2 (only metric dimension)

### Advantages:

- the advantage of the NS profile is its special shape, which enables working on heavily damaged nuts
- A nut with damaged corners cannot be loosened with a standard socket, but a wrench with an NS profile does the job easily.

### Technical Data

Barcode	UNIOR	D1	D2	L	T	Weight	Material	Quantity	Unit
618925	10	15.6	22.6	38.1	7.5	70	4B	5	1
619144	11	17.8	22.6	38.1	8.5	72	4B	5	1
619145	12	18.2	24.3	38.1	10	85	4B	5	1
618926	13	19.3	24.3	38.1	10	85	4B	5	1
618927	14	22	24.3	38.1	10.5	87	4B	5	1
618928	15	23.2	26.6	38.1	10.5	108	4B	5	1
618929	16	24.3	26.6	38.1	12	108	4B	5	1
618930	17	25.4	26.6	38.1	12.5	108	4B	5	1
618931	18	26.6	26.6	38.1	12.5	108	4B	5	1
618932	19	28.3	28.3	38.1	12.5	118	4B	5	1
618933	21	31.5	31.5	38.1	14	150	4B	5	1
618934	22	33.1	33.1	38.1	14	167	4B	5	1
618935	23	33.8	33.8	44.5	16	207	4B	5	1
618936	24	34.8	34.8	44.5	16	208	4B	5	1
618937	25	36.4	36.4	44.5	19.5	222	4B	5	1
618938	26	37.8	37.8	50.8	19.5	276	4B	5	1
618939	27	39.4	39.4	50.8	20	287	4B	5	1

### Packaging data

Barcode	UNIOR	Retail tool packaging					Transport package			
		A	B	C	Weight	Quantity	A1	B1	C1	Weight
618925	10	105	44	43	75	4	93	144	57	425
619144	11	105	44	43	77	4	93	144	57	433
619145	12	105	44	43	90	4	93	144	57	485
618926	13	105	44	43	90	4	93	144	57	485
618927	14	105	44	43	92	4	93	144	57	493
618928	15	105	44	43	113	4	93	144	57	577
618929	16	105	44	43	113	4	93	144	57	577
618930	17	105	44	43	113	4	93	144	57	577
618931	18	105	44	43	113	4	93	144	57	577
618932	19	105	44	43	123	4	93	144	57	617
618933	21	105	44	44,75	155	4	93	144	57	745
618934	22	105	44	45,55	172	4	93	144	57	813
618935	23	110	44	45,9	212	4	93	144	57	973
618936	24	110	44	46,4	213	4	93	144	57	977
618937	25	110	44	47	227	4	93	144	57	1033
618938	26	120	44	47,65	281	4	93	144	57	1249
618939	27	120	44	48,7	292	4	93	144	57	1293