

# Inner bearing puller

689/2BI

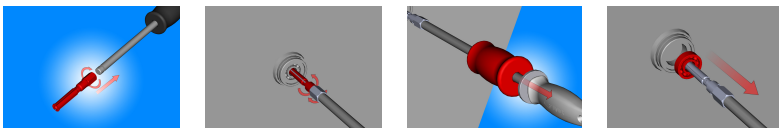

## Usage



## Profiles



[./eng/support/warranty\).](#)

## Product features

- material: premium chrome vanadium steel
- drop forged, entirely hardened and tempered
- surface finish: chrome plated according to ISO 1456:2009
- ergonomic heavy duty double component handle

## Advantages:

- Set includes 6 pcs of arm for inner bearing dimensions 6.5-8,10-12, 12-15, 17-20, 22-28, 30-36

## Usage:

- It is used for pulling different types of bearings. The bearing is

gripped from the inside side and pulled out.

- the bearing is extract with a 1 kg weight

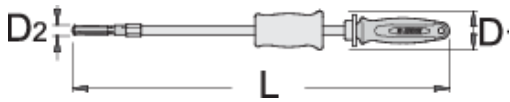

Barcode	D1	D2↓	D2↑	L↓	L↑	Weight
622587	52	6,5	36	495	555	3300

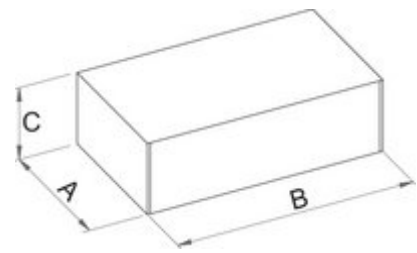

### Retail packaging

Barcode	MA	MB	MC	Weight
622587	200	455	55	3300

### Transport packaging

Barcode	Hand	TA	TB	TC	Weight
622587	1	200	455	55	3300

### Spare parts

 Arm for 689/2BI