

Plastic tool box

917A



Usage



Profiles



[./eng/support/warranty.](#)

Product features

- material: polypropylene
- with removable tool tray inside the box
- lid contains two compartments in dimension L80 x B140 x H35 mm covered with plastic cover
- closing with plastic clip
- box can be locked with padlock

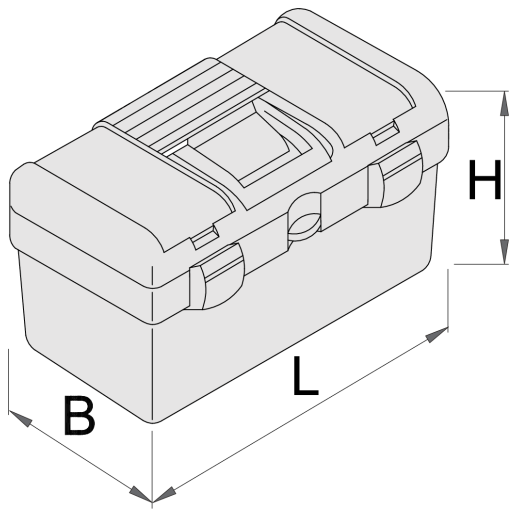

Barcode	L	B	H	Icon
---------	---	---	---	------

619765	514	280	260	1930
--------	-----	-----	-----	------

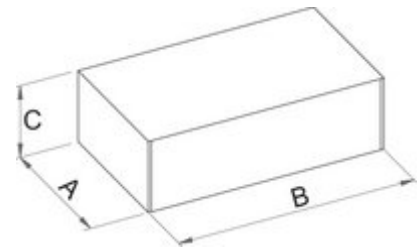

Retail packaging

Barcode	MA	MB	MC	Icon	ean	cat.nr.	Packaging
---------	----	----	----	------	-----	---------	-----------

619765	280	514	260	2000	3838909197654	10	General laminated boxes
--------	-----	-----	-----	------	---------------	----	-------------------------

Transport packaging

Barcode	Icon	TA	TB	TC	Icon
---------	------	----	----	----	------

619765	1				
--------	---	--	--	--	--