

# Bottom bracket shell installation tool

1607/4



## Profiles



[\\_\(/eng/support/warranty.\)](#)

## Product features



- material: premium flex plus carbon steel
- surface finish: blacken to standard DIN 50938

## How to use the tool:

- This tool is used for the installation and removal 35. 8 mm and 36. 3 mm bottom bracket shell. It is made of precision tool steel with heat treatment and surface protection. The advantage

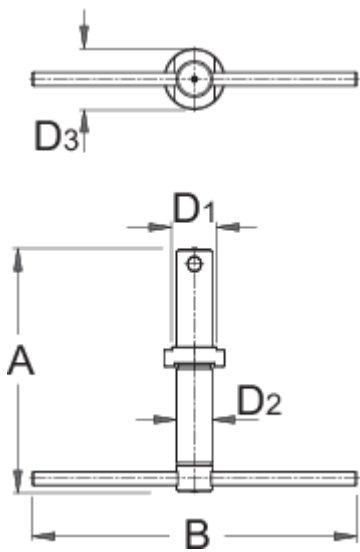

of the tool is that it prevents slipping off the shell.

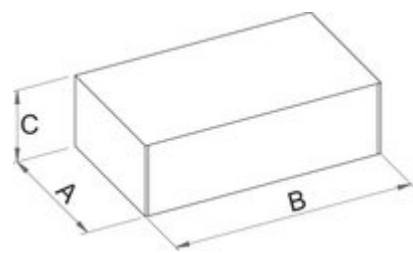

	A	B	D1	D2	D3	
616293	220	290	36,5	32	54	1750



Retail packaging

	MB	MC	MA	
616293	325	60	75	1820

Transport packaging

		TB	TC	TA	
616293	1				

Spare parts



Spare head for 1607/4