

Bottom bracket socket T47

1671.T47



Profiles



Product features

- T47 double sided bottom bracket socket features 16 and 12 notch interface with exchangeable adaptor to cover all different T47 bottom bracket standards.

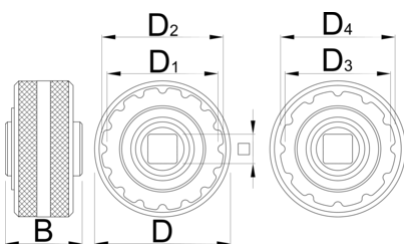

D

B



D1

D2

D3

D4

360°/n

360°/n





D

B



D1

D2

D3

D4

360°/n

360°/n



628495

60

34

1/2"

49

54

46.6

51

16

12

106

* Images of products are symbolic. All dimensions are in mm, and weight in grams. All listed dimensions may vary in tolerance.

Usage (pictures)



BOTTOM BRACKET SOCKET

All models of bottom bracket sockets are precision CNC machined tools for installation and removal of different external bottom bracket cups. They are made of aluminum billet and anodized red for durable finish and precise fit, that won't damage aluminum external bottom bracket cups.

Knurling on the side of the socket creates better grip when threading cups by hand, meanwhile 1/2" square drive makes it easy to use with torque wrenches, ratchets and fixed handles.

BB9000



SKU	ID
627619	1671.BB9000

BBR60



SKU	ID
627620	1671.BBR60

BSA30



SKU	ID
627621	1671.BSA30

MegaEVO



SKU	ID
627622	1671.MEVO

16 Notch



SKU	ID
627623	1671.16N

T47



SKU	ID
628495	1671.T47

NEW

E13



SKU	ID
629358	1671.E13

NEW

HOPE



SKU	ID
629359	1671.HP

BOTTOM BRACKET		UNIOR TOOL							
MANUFACTURER	MODEL	BB9000	BBR60	BSA30	MegaEVO	16Notch	T47	E13	HOPE
Campagnolo	Fits most models					X			
Chris King	Fits most models					X			
Chris King	Thread fit T47 30I & 24I						X		
Chris King	Thread fit T47 30X & 24X						X		
Enduro	T47 with OD 52.2mm						X		
Enduro	TorqueTite PF30 with OD 52.2mm						X		
FSA	MegaEvo				X				
FSA	MegaEvo					X			
Praxis	T47*						X		
Race Face	Cinch			X					
Race Face	X-Type					X			
Rotor	BSA30			X					
Shimano	BBR60		X						
Shimano	Dura-Ace 9000	X							
Shimano	Hollowtech II					X			
Shimano	MT60		X						
Shimano	XTRBB93	X							
SRAM	DUB T47						X		
SRAM	DUB			X					
SRAM / Truvativ	GXP					X			
Zipp	Vuma			X					
Hawk Racing	BB3086			X					
Wheels Mfg	PF30				X				
Wheels Mfg	T47						X		
Hope	30 Threaded								X
E13	Threaded							X	

*1671.T47 is not compatible with Praxis T47 GXP non drive side cup.

A = Notch diameter
 B = Socket diameter
 C = Guide diameter
 D = Guide adapter diameter

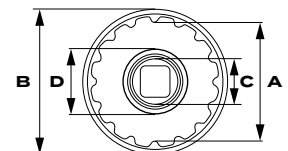

UNIOR BOTTOM BRACKET SOCKETS SPECIFICATIONS					
TOOL	# NOTCHES	NOTCH DIAMETER	SOCKET DIAMETER	GUIDE DIAMETER	GUIDE ADAPTER DIA.
BSA 30	12	44,2	53	/	/
BBR 60	16	39	47	/	/
BB9000	16	39,4	45	/	/
MegaEVO	16	46,4	56	/	/
16 Notch	16	42,7	52	/	/
T 47	16	49	60	23,8	28,8
T 47	12	46,6	60	23,8	29,8*
E13	6	49,5	54,5	/	/
HOPE	16	47,6	55	/	/

* Adapter is exchangeable and can be used on both sides.