

# V adaptor for rear stand

3001.2



## Profiles



[\\_\(/eng/support/warranty\).](#)

## Product features

- material: constructional steel
- surface finish: chrome plated according to ISO 1456:2009



## Advantages:

- quick-change adaptors and setting stands
- reliable mounting into the groove of the motorcycle front fork

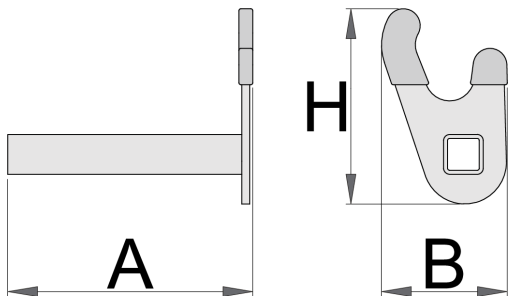

## Usage:

- reliable mounting on side pin of the rear swinging arm of the motorcycle
- it is suitable for almost all type of motorbikes
- use together with base 3001.3



	A	B	H	
624327	124	63	98	440

Retail packaging

	MA	MB	MC	
624327	100	100	60	394

Transport packaging

		TA	TB	TC	
624327	1				