

Valve seal removal set for motorbikes

3059

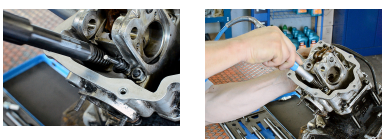

Usage



Profiles



[./\(eng/support/warranty\).](#)

Product features

- material: premium plus carbon steel, polyethylene
- surface finish: chrome plated according to ISO 1456:2009
- Dimension of box: 321 x 198 x 54

Advantages:

- enables the removal of valve seals without removing the head of the motor
- accessories for assembling pins from fi 5mm to fi 9 mm
- the accessories cover the following dimensions of spark plugs M10x1, M12x1.25, M14x1.25 and M18x1.5

- accessories for removing pins diameter fi 8mm, fi 13 mm and fi 16 mm
- accessories for assembling seals fi 12 and fi 14mm

Usage:

- The individual piston is set into a lower position. In the place of the spark plug, an attachment for the pressure pipe is connected; the cylinder is filled with compressed air, which enables the valves to stay in the upper position.
- Find an appropriate attachment for pulling the pin, set it onto the cover of the spring, straighten the magnets with pins and press the springs by pushing with your hand.
- This enables the pins to be removed from the groove of the valve.
- Remove the cover and the springs.
- Take the valve seal removal pliers art. 2201/2BI, pull out the seals, take the accessories for assembling the seals, place the new seals.
- Place back the springs and the cover; place the pins and use the accessories for assembling the pins to compress the springs by hand, which enables the placement of the pins back onto the valve.
- Repeat the same procedure on all other valves, then remove the accessories for the pressure pipe and repeat the procedure on the next cylinder





623219



2100

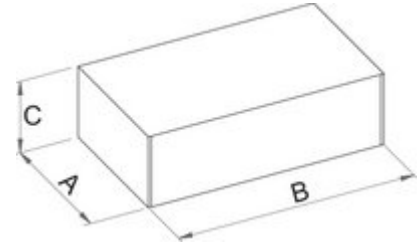

Retail packaging

	MA	MB	MC	
623219	200	320	55	2100

Transport packaging

		TA	TB	TC	
623219	1				