

DRIVA NYLON



Fixing for plasterboard polyamide, for light loads, complete with screw, for fixing frames, moldings, lamps on plasterboard and concrete phones

TECHNICAL DATA

Plug material:	polyamide 6.6 fiber glass reinforced, neutral color
Screw material:	carbon steel, treated with zinc plating Cr ³⁺ thickness $\geq 5\mu\text{m}$
Installation temperature:	0°C ÷ +40°C
Working temperature:	-40°C ÷ +80°C

BUILDING MATERIALS



INSTALLATION METHOD

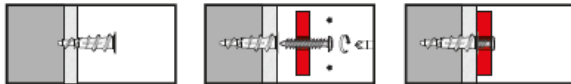

CHARACTERISTICS/BENEFITS

- ▶ Zinc-plated steel rounded head screw.
- ▶ Self-drilling special geometry.
- ▶ Easy and quick installation with a screwdriver with no pre-drilling.
- ▶ The white color prevents imperfections of the plug on the wall.
- ▶ The screw with washer under head allows a sure anchorage of flexible objects in plastic materials.